

BC.3.50 INTERMEDIATE MODULE FOR PRESSURE GAUGE CONNECTION

- BC** Module base
- 3** CETOP 3/NG6
- 50** Intermediate module for pressure gauge connection at ports A/B/P/T
- 00** No variant
- 1** Serial No.

Weight: 1 Kg

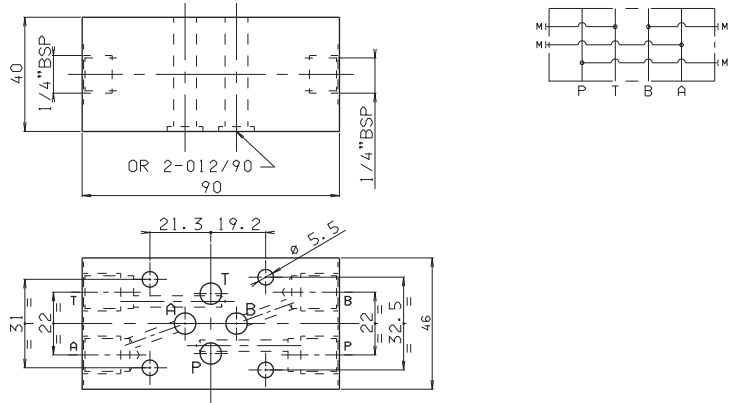

BC.3.51 DOWEL BASE PLATE FOR SOLENOID VALVE

- BC** Module base
- 3** CETOP 3/NG6
- 51** Dowel base plate
- 00** No variant
- 1** Serial No.

Weight: 0.2 Kg
K = plate OR (Q25.95.0001)

CALIBRATED DIAPHRAGMS AVAILABLE	
d	M8x1x8
0.6	M89.10.0007
0.7	M89.10.0008
0.8	M89.10.0009
0.9	M89.10.0012
1	M89.10.0010
1.2	M89.10.0011
1.4	M89.10.0038
1.5	M89.10.0035
1.75	M89.10.0042
2	M89.10.0041
2.5	M89.10.0036

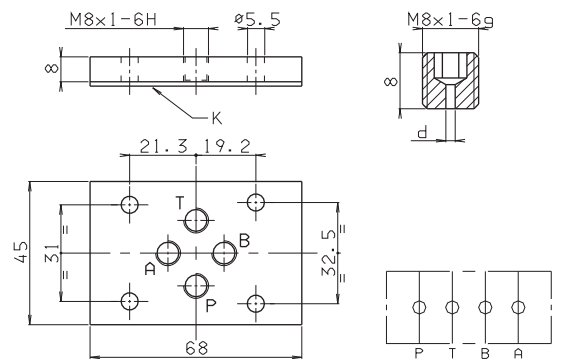

BC.3.07 BASE PLATE FOR DOUBLE FLOW RATE P→A AND B→T

- BC** Module base
- 3** CETOP 3/NG6
- 07** bases plate for twin flow rate
- 00** No variant
- 1** Serial No.

Weight: 0,5 Kg

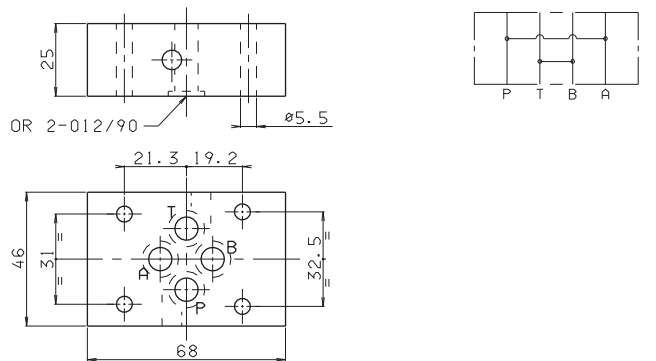

BC.3.107 BASE PLATE FOR USING 4 WAY VALVE AS 2 WAY ONLY

- BC** Module base
- 3** CETOP 3/NG6
- 107** base for using 4 way valve as 2 way only
- 00** No variant
- 1** Serial No.

Weight: 0,5 Kg

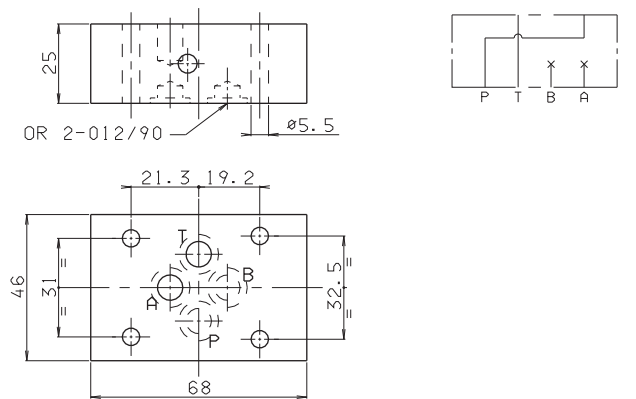

7

BC.3.08 INTERMEDIATE BASE PLATE FOR XQ.3... (P → A)

- BC** Module base
- 3** CETOP 3/NG6
- 08** Base plate for XQ3 (P→A)
- 00** No variant
- 1** Serial No.

Weight: 1,5 Kg

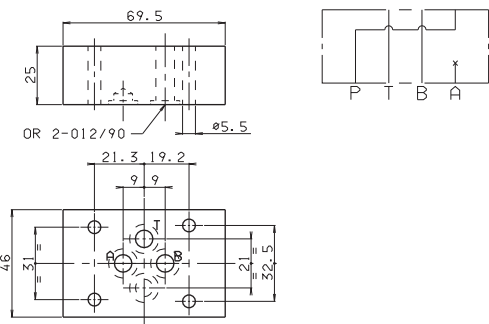

BC.3.09 INTERMEDIATE BASE PLATE FOR XQ.3... (B → P)

- BC** Module base
- 3** CETOP 3/NG6
- 09** Base plate for XQ3 (B→P)
- 00** No variant
- 1** Serial No.

Weight: 1,4 Kg

• To take advantage of this base it is necessary to operate with the pump at connector A of the multi station base plate

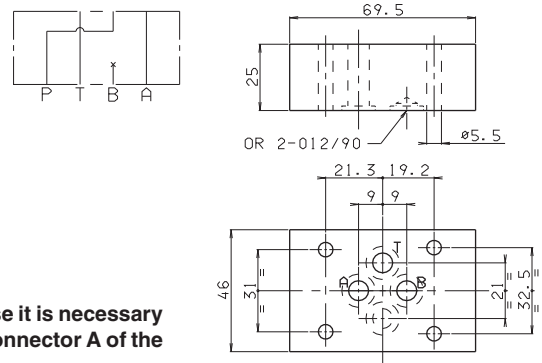

BC.06.XQ3 BASE PLATE FOR PROPORTIONAL VALVE TYPE XQ.3...

- BC** Module base
- 06** CETOP 3/NG6
- XQ3** base plate XQ3
- 00** No variant
- 1** Serial No.

Weight: 1,4 Kg

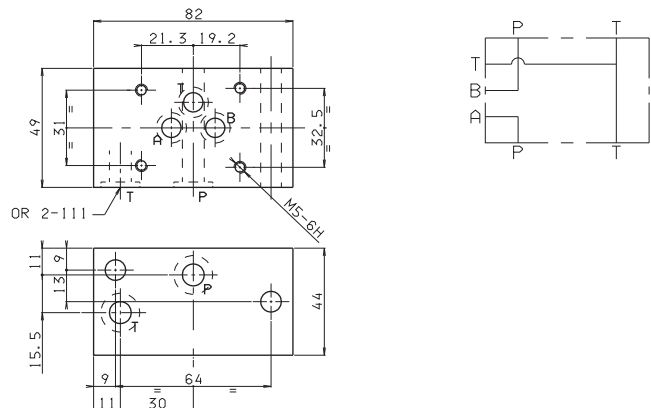

BC.06.XQP3 BASE PLATE FOR PROPORTIONAL REGULATOR TYPE XQP.3...

- BC** Module base
- 06** CETOP 3/NG6
- XQP3** Base for XQP3 proportional regulator
- 00** No variant
- 1** Serial No

Weight: 1,4 Kg

